

\$575,295 - 260 Bellerose Drive, St. Albert

MLS® #E4404682

\$575,295

2 Bedroom, 2.00 Bathroom, 1,088 sqft
Condo / Townhouse on 0.00 Acres

Oakmont, St. Albert, AB

Welcome to Riverbank Landing!! A premium mixed use development located on the banks of the Sturgeon River Valley. This spacious 2 bedroom suite (1,088 sf) offers quality features throughout including; 9ft ceilings, oversized windows, quartz countertops, plank flooring, porcelain tile, cozy linear style fireplace, premium appliance pkg & much more!! Underground parking & storage.. spacious 216 sf covered balcony with water & gas hookup. Solid concrete & steel construction. Dedicated fresh air intake with forced air heating & A/C. Well designed amenities include; spacious event centre, impressive 2 story lobby with 3 elevators, rooftop patio, residents lounge, fitness facility, guest suite, car wash etc. Still time to choose your interior finishings and take possession in the fall of 2025. Enjoy the condo lifestyle only steps to boutique shopping, unique restaurants, professional services and direct access to the over 65 kms of the Red Willow Trail System.

Built in 2024

Essential Information

MLS® #	E4404682
Price	\$575,295
Bedrooms	2
Bathrooms	2.00

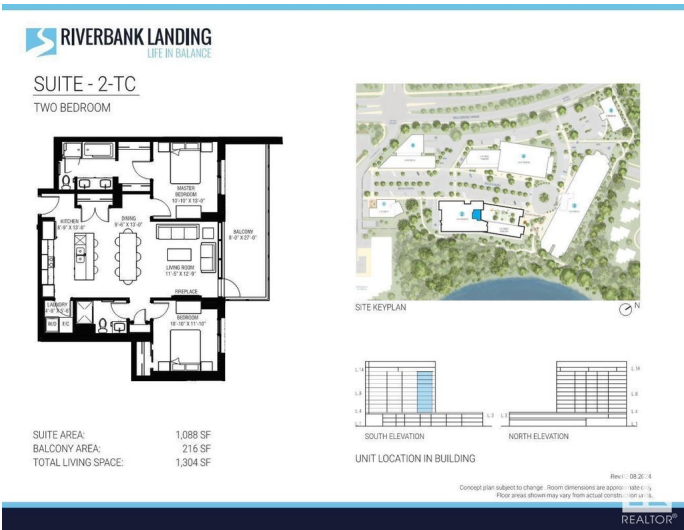

Full Baths	2
Square Footage	1,088
Acres	0.00
Year Built	2024
Type	Condo / Townhouse
Sub-Type	Apartment High Rise
Style	Single Level Apartment
Status	Active

Community Information

Address	260 Bellerose Drive
Area	St. Albert
Subdivision	Oakmont
City	St. Albert
County	ALBERTA
Province	AB
Postal Code	T8N 7P7

Amenities

Amenities	Car Wash, Detectors Smoke, Guest Suite, Parking-Visitor, Recreation Room/Centre, Sprinkler System-Fire, Storage-In-Suite
Parking	Stall, Underground

Interior

Interior Features	ensuite bathroom
Appliances	Dishwasher-Built-In, Microwave Hood Fan, Oven-Built-In, Refrigerator, Stacked Washer/Dryer, Stove-Countertop Electric
Heating	Fan Coil, In Floor Heat System, Electric, Water
# of Stories	14
Stories	1
Has Basement	Yes
Basement	None, No Basement

Exterior

Exterior	Concrete, Metal, Stucco
Exterior Features	Golf Nearby, Landscaped, Park/Reserve, Public Transportation, River Valley View
Roof	EPDM Membrane
Construction	Concrete, Metal, Stucco

Foundation Concrete Perimeter

Additional Information

Date Listed September 3rd, 2024
Days on Market 285
Zoning Zone 24
Condo Fee \$530

DATA IS DEEMED RELIABLE BUT IS NOT GUARANTEED ACCURATE BY THE REALTORS® ASSOCIATION OF EDMONTON. COPYRIGHT 2025 BY THE REALTORS® ASSOCIATION OF EDMONTON. ALL RIGHTS RESERVED.Trademarks are owned or controlled by the Canadian Real Estate Association (CREA) and identify real estate professionals who are members of CREA (REALTOR®, REALTORS®) and/or the quality of services they provide (MLS®, Multiple Listing Service®)
Listing information last updated on June 15th, 2025 at 3:32pm MDT